

Moving to Year 1

We are really looking forward to seeing you in September.
Here is some Year 1 information to help you to settle into your new class.

Year 1 Class Teachers



Miss Hill
Base 1



Miss Buckingham
Base 2

Teaching Assistants in Year 2



Mrs Wilmot
Teaching Assistant



Mrs Goodwin
Teaching Assistant

Year group entrance and lining up

On the next page, you will see a map which will show you where to line up and which entrance to use for your child's new class.

What to bring on your first day

- Water bottle with your child's name on
- Packed lunch (if required)

P.E. Days

Tuesday- (Indoor-gymnastics) Thursday- (Outdoor- multi-skills)

PE uniform reminder - see school policy.

Forest School Days - Autumn term 1 - - Please bring a change of clothes (items labelled) and sensible/waterproof footwear and a coat. Forest school will take place on a Friday afternoon.

Homework

As part of Y1's homework, children will be expected to read **at least three times** a week.

- Children will be quizzed on their Jump and Orange Words (JOW) at the end of each half term (these can be found in their reding diary).

Please encourage your child to enter and exit independently.

Newdale Primary & Nursery School Site Map

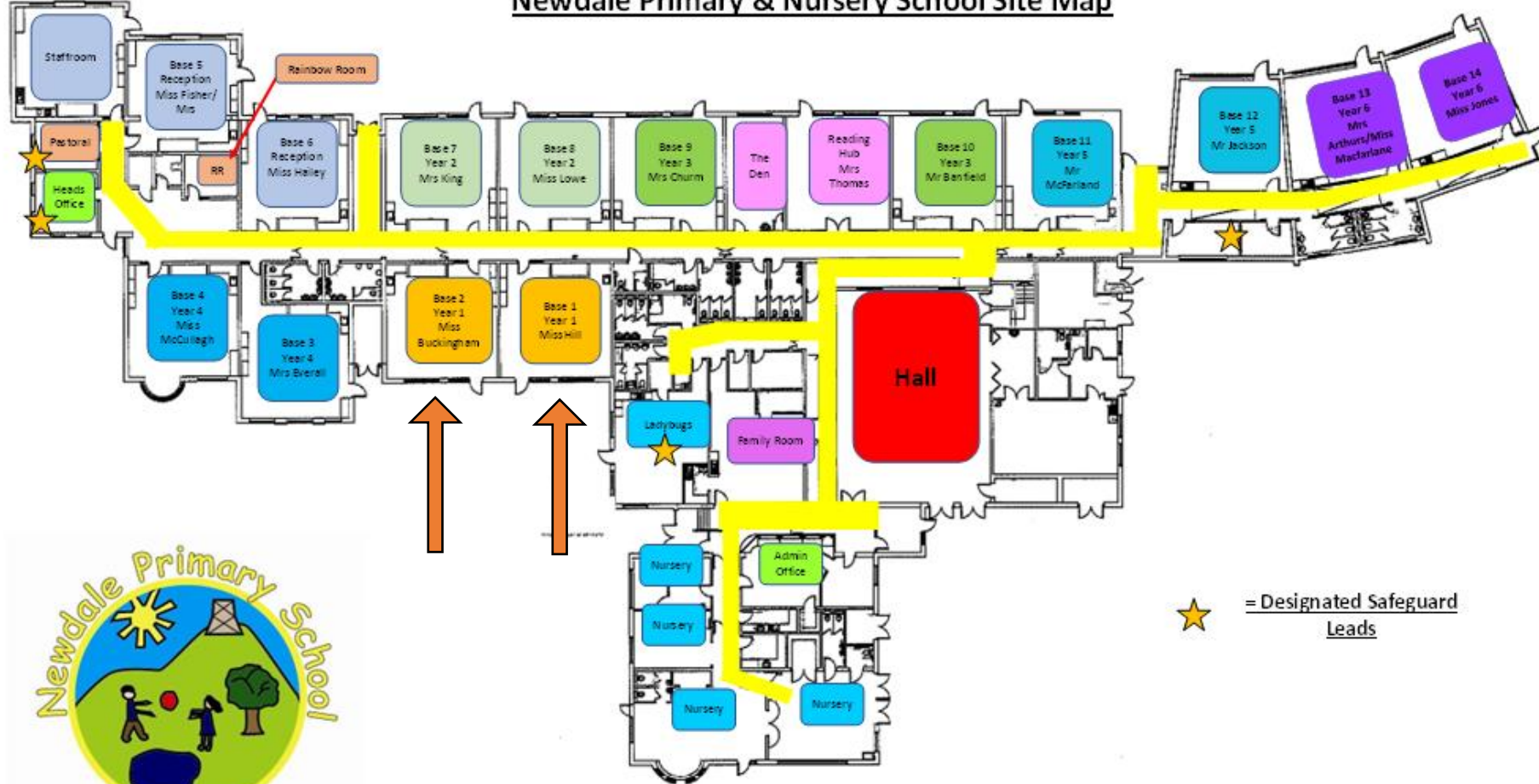

★ = Designated Safeguard Leads

