

Moving to Year 2

We are really looking forward to seeing you in September.
Here is some Year 2 information to help you to settle into your new class.



Miss Lowe
Base 8

Year 2 Class Teachers

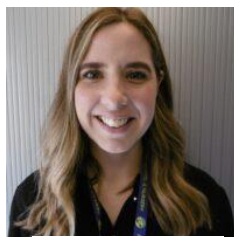

Mrs King
Base 7

Teaching Assistants in Year 2



Mrs Stevens
Teaching Assistant



Miss Marshall
Teaching Assistant

Year group entrance and lining up

On the next page, you will see a map which will show you where to line up and which entrance to use for your child's new class.

What to bring on your first day

- Water bottle with your child's name on
- Packed lunch (if required)

P.E. Days

- Monday (Outdoor) - Friday (Indoor)

PE uniform reminder – see school policy.

Outdoor Learning Days – Autumn term 1 - **Wednesdays** – Please bring a change of clothes (items labelled) and sensible/waterproof footwear and a coat.

Homework

As part of Y2's homework, children will be expected to read **at least three times** a week and regularly practise their spelling and times tables. New homework sheets will be given out each **Friday**. Please ensure your child brings their homework book each **Thursday** (to be checked) and every Friday where they will complete their spelling quiz.

- Children will be quizzed on their **spellings every Friday** (in the back of their homework books). These will be practised and assessed at the **end of each half term**. - Children will be tested on their **times tables every Wednesday**.

Please encourage your child to enter and exit independently

Newdale Primary & Nursery School Site Map

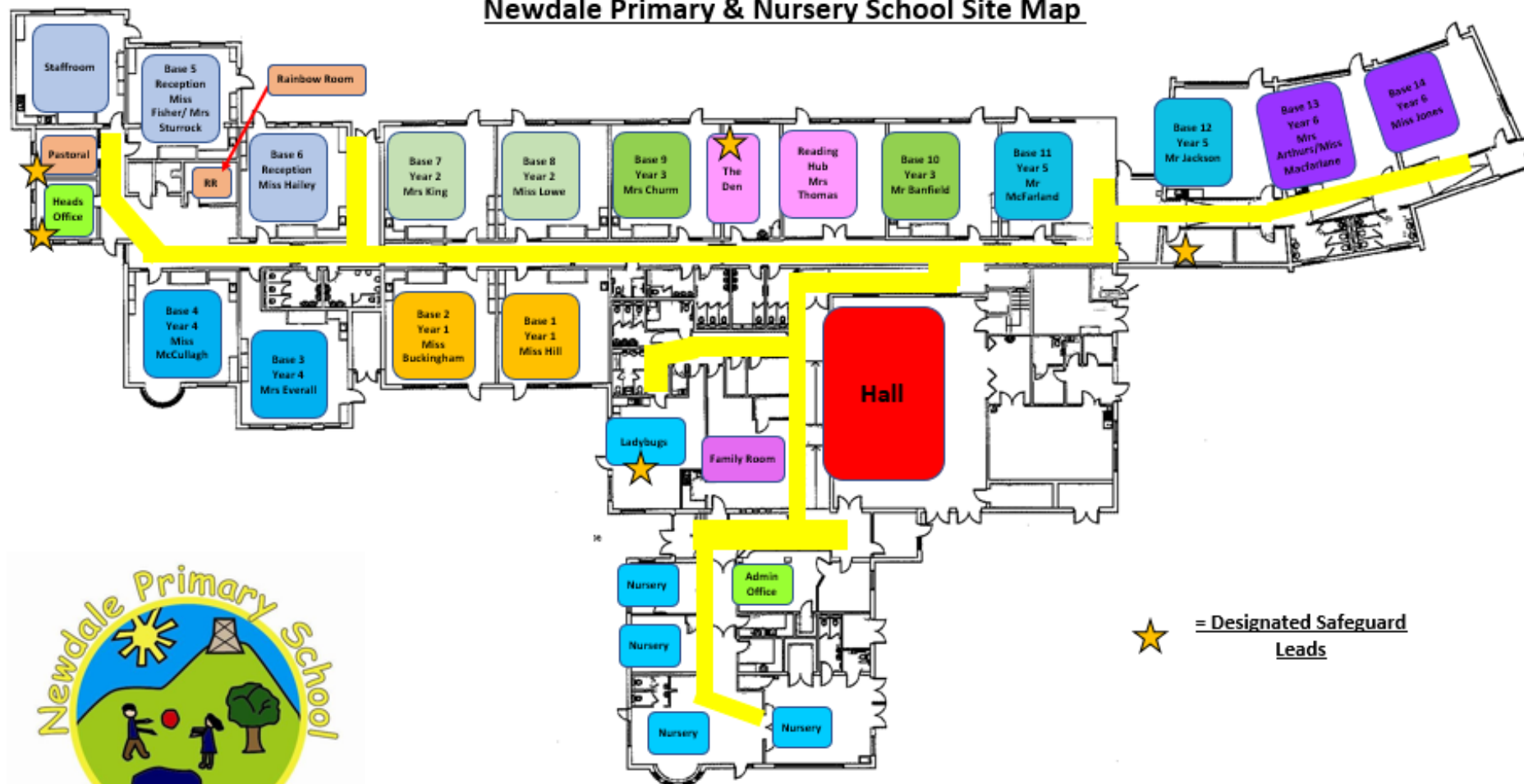

★ = Designated Safeguard Leads