

Moving to Year R

We are really looking forward to seeing you in September.
Here is some Year R information to help you to settle into your new class.

Year R Class Teachers



Miss Buckingham
Base 5

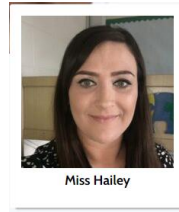

Miss Hailey
Base 6

Other staff who work in Year R



Mrs Bissell
Base 5
Teaching Assistant



Miss Hodgetts
Teaching Assistant across both
classes



Mrs Cleobury
Base 6
Teaching Assistant

Year group entrance and lining up

On the other side of this sheet you will see a map which will show you the entrance to use for your new class.

You will need to bring to school daily

- Packed lunch (if required: Starting from Friday 6th September)
- Coat (clearly named)
- 1 school bookbag
- Water bottle

P.E. will be a Monday (Outdoor PE) and Thursday (Indoor PE). Starting Week 2. Please wear PE kits on these days.

Forest School days will be Wednesday starting Week 3. Please bring kits and wellies in a separate bag for this day. More information to follow.

Homework

It will really help your child to make excellent progress if you read nightly with them. We will change books daily, providing a 'share a story' book which is intended to be read together to encourage reading for pleasure. In addition to this we also periodically set Parents as Partners tasks. These will be a variety of fun and practical tasks that relate to the learning going on in school at that time. It provides the opportunity for your child to extend their knowledge and skills as well as keeping you up to date of what they have been or will be doing soon.

Newdale Primary & Nursery School Site Map

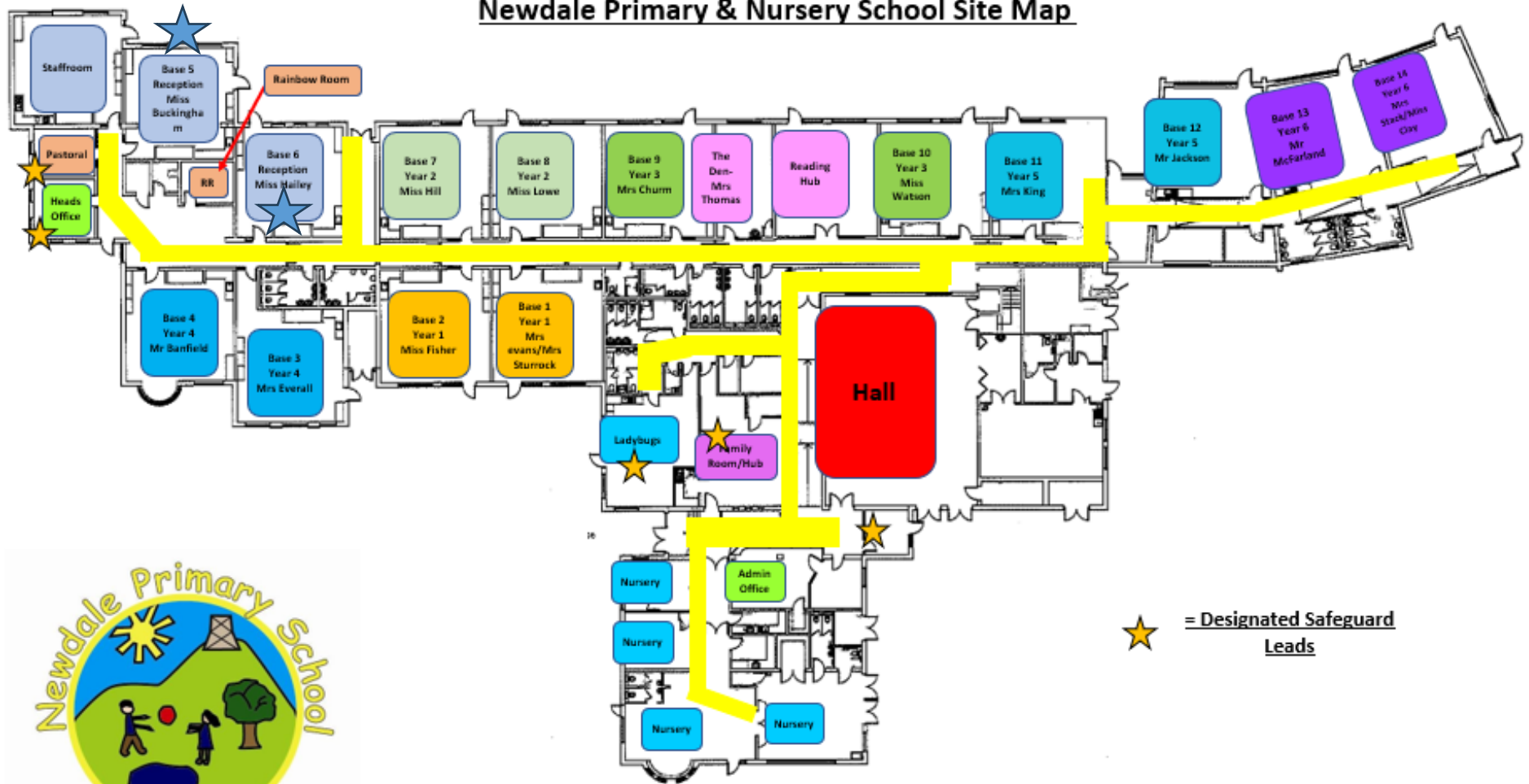

★ = Designated Safeguard Leads

